



# DAW Power Technology Co., Ltd

The future leader of lithium batteries

TOP 10 CHINA professional lithium battery supply

[www.dawpower.com](http://www.dawpower.com)

Done Always WIN

**1** Company Profile

**2** Products

**3** Factory Display

**4** Contact Us



# Company Profile

DAW Power Technology Co., Ltd is an innovative enterprise focusing on independent research and development, production and sales of battery products, mainly engaged in battery-related products and services such as ternary lithium batteries, lithium iron phosphate batteries, battery lithium titanate batteries, solar modules, and special demand batteries. The company adheres to scientific and technological innovation as the core, and is committed to becoming the world's leading provider of battery products and solutions.

The company's existing lithium battery customized solutions and products are widely used in backup power, aerospace, AGV, robots, electric forklifts, medical electronics, transportation logistics, solar photovoltaics, home energy storage, outdoor electronics, instrumentation, car starting, electric wheelchairs, Cleaning equipment, rail transit and other fields.

The factory covers an area of more than 50000 m<sup>2</sup>, has more than 50 million yuan in fixed assets, and has more than 200 employees, including nearly 150 skilled workers in industrial design, electronics, power supply, structure, technology, software, measurement and control, electrochemistry and other professional technical categories.

The company has passed ISO9001 Quality Management System Certification, ISO14001 Environmental Management System Certification, and OHSAS18001 Occupational Health and Safety Management System Certification. The company's products have passed many international tests and gained certifications such as PSE, FCC, CE, UN38.3, ROHS, etc., and we strive to meet international standards in every production section.

# Low speed power battery



Our low-speed car lithium batteries can be used for two wheeled vehicles, three wheeled vehicles, and four wheeled sightseeing vehicles.

We also provide customized services to meet your needs.

**Low speed power battery**

Parameter	48V20Ah	48V30Ah	60V20Ah	60V30Ah	60V40Ah	60V45Ah	72V20Ah
Rated voltage (V)	48	48	60	60	60	60	72
Rated capacity(Ah)	20	30	20	30	40	45	20
Maximum continuous current(A)	≤30	≤45	≤30	≤45	≤60	≤67.5	≤30
Normal operating current(A)	10	15	10	15	25	25	15
Battery weight(KG)	6.5	10.87	8.26	15.92	19.82	18	10
Battery size(mm)	230*156*165	330*170*215	260*160*175	365*160*190	320*230*195	395*225*170	230*180*170

# LiFePO<sub>4</sub> Power battery

Picture



Model	12.8V100Ah	48V12Ah	48V16Ah	48V16Ah	48V20Ah
Rated voltage(V)	12.8	48	48	48	48
Rated capacity(Ah)	100	12	16	16	20
Discharge current(A)	≤100	≤12	≤16	≤16	≤20
Battery size(mm)	380*380*520	240*155*110	322*176*110	178*104*325	240*155*110
Power cell	26700	26700	26700	26700	26700
Product weight(Kg)	44.5	7.02	8.2	7.8	7.02

# LiFePO<sub>4</sub> Power battery

Picture



Model	48V20Ah	48V20Ah	48V20Ah	48V23Ah	48V30Ah
Rated voltage(V)	48	48	48	48	48
Rated capacity(Ah)	20	20	20	23	30
Discharge current(A)	≤20	≤20	≤20	≤23	≤30
Battery size(mm)	178*104*325	194*164*256	250*178*140	240*155*110	180*150*290
Power cell	26700	26700	26700	26700	26700
Product weight(Kg)	7.02	10.1	10.56	7.02	6.8

# LiFePO<sub>4</sub> Power battery

Picture



Model	51.2V20Ah	51.2V20Ah	25.6V120Ah	51.2V100Ah	60V25Ah
Rated voltage(V)	48	48	24	51.2	60
Rated capacity(Ah)	20	20	120	100	25
Discharge current(A)	≤20	≤20	≤120	≤100	≤25
Battery size(mm)	287*180*134	330*180*160	337*250*233	460*360*190	194*164*256
Power cell	32800	32800	32800	32800	32800
Product weight(Kg)	7.02	10.1	30.05	42.55	12.5

# LiFePO<sub>4</sub> Power battery

Picture



Model	64V20Ah	64V30Ah	64V40Ah	64V54Ah	51.2V20Ah
Rated voltage(V)	64	64	64	48	60
Rated capacity(Ah)	20	30	40	20	20
Discharge current(A)	≤20	≤30	≤40	≤20	≤20
Battery size(mm)	190*180*181	282*245*200	282*245*200	190*260*360	330*180*160*
Power cell	32800	32800	32800	32800	26700
Product weight(Kg)	12	17.02	22	28	10.1



# LiFePO<sub>4</sub> STARTING BATTERY

Picture



Model	12.8V50Ah	12.8V150Ah	12.8V200Ah	12.8V250Ah	12.8V300Ah
Rated voltage(V)	12.8	12.8	12.8	12.8	12.8
Rated capacity(Ah)	50	150	200	250	300
Working voltage(V)	10-14.6	10-14.6	10-14.6	10-14.6	10-14.6
Battery size(mm)	198*166*170	520*269*220	520*269*220	520*269*220	520*269*220
Work Temperature	-20°C~60°C	-20°C~60°C	-20°C~60°C	-20°C~60°C	-20°C~60°C
Charging current (A)	20	50	100	100	100
Continuous discharge (A)	50	150	150	150	150
Battery Cycling Life	>2000	>2000	>2000	>2000	>2000
Level of protection	IP67	IP67	IP67	IP67	IP67

# LiFePO<sub>4</sub> STARTING BATTERY

Picture						
Model	12V50Ah	12V100Ah	12V40Ah	12V50Ah	12V75Ah	
Rated voltage(V)	12	12	12	12	12	
Rated capacity(Ah)	50	100	40	50	75	
Working voltage(V)	10-14.6	10-14.6	10-14.6	10-14.6	10-14.6	
Battery size(mm)	260*165*185	325*165*165	520*269*220	520*269*220	520*269*220	
Work Temperature	-20°C~60°C	-20°C~60°C	-20°C~60°C	-20°C~60°C	-20°C~60°C	
Charging current (A)	20	50	25	25	36	
Continuous discharge (A)	50	100	40	50	75	
Battery Cycling Life	>2000	>2000	>2000	>2000	>2000	
Level of protection	IP67	IP67	IP67	IP67	IP67	







# LiFePO<sub>4</sub> Energy Storage Battery

Picture				
Model	12.8V100Ah	51.2V100Ah	51.2V100Ah	51.2V100Ah
Rated voltage(V)	12.8	51.2	51.2	51.2
Rated capacity(Ah)	100	100	100	100
Discharge current(A)	≤100	≤100	≤100	≤100
Battery size(mm)	392*172*214	630*400*171	630*400*185	630*400*170
cell	32700	32700	32700	32700
Product weight(Kg)	10	50.5	55	50

# LiFePO<sub>4</sub> Large energy storage series

## 1 MWh Microgrid Energy Storage System

Function	Peak cut、Reserve electricity
Battery Type	LiFePO <sub>4</sub>
Type of energy storage system	Grid connection、Off grid
Rated capacity	1MWH
Battery box	128
Battery size(mm)	12192*2438*2896
Communication mode	CAN/RS485
Battery cabinet	16
AC rated voltage	AC380V

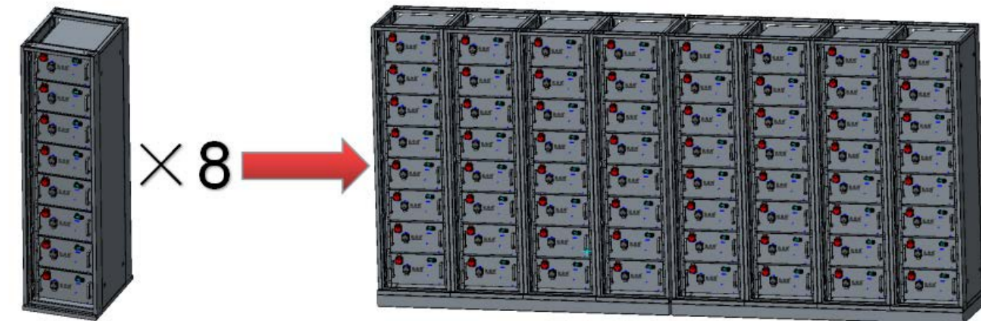
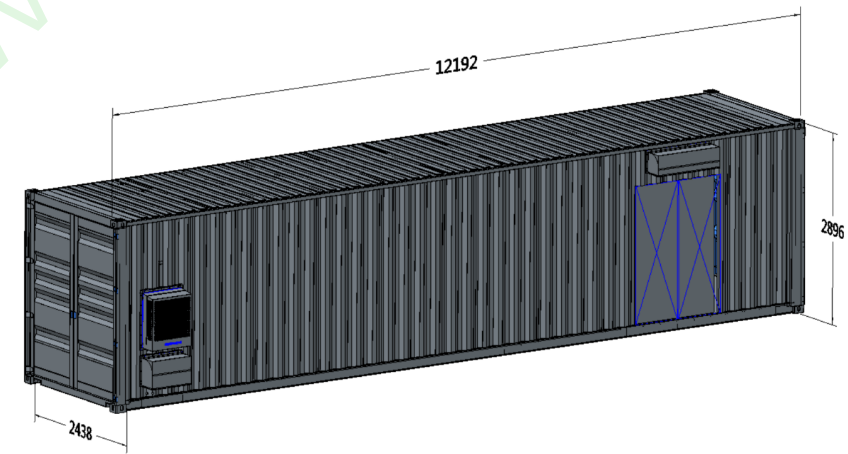

Figure 5-6 Structure of the battery rack

# LiFePO<sub>4</sub> Battery cell series

Safe  
Powerful efficient  
Durable

Model	Voltage(V)	Capacity(mAh)	Nominal current (A)
14430	3.2	250	0.25
14500	3.2	400	0.4
14500	3.2	600	0.6
18500	3.2	850	0.85
21700	3.2	3000	3.0
26650	3.2	3300	3.3
26700	3.2	4000	4.0
32700	3.2	5500	5.5
32700	3.2	6000	6.0
32800	3.2	7500	7.5



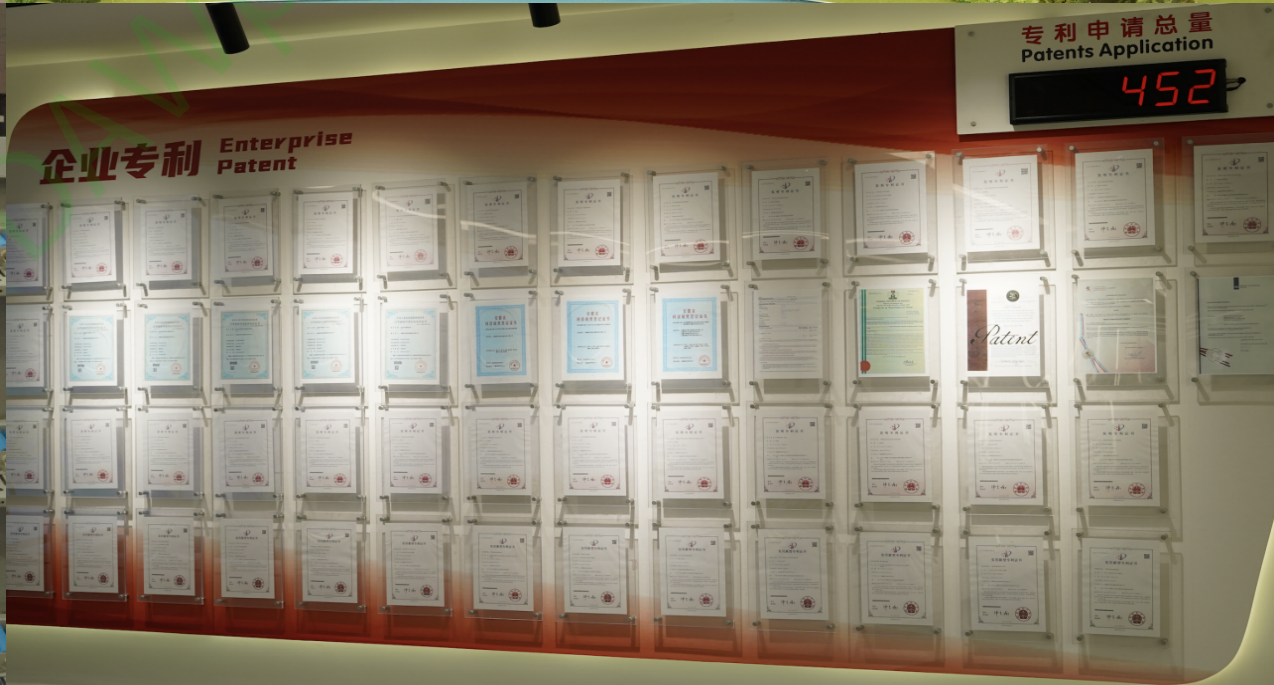
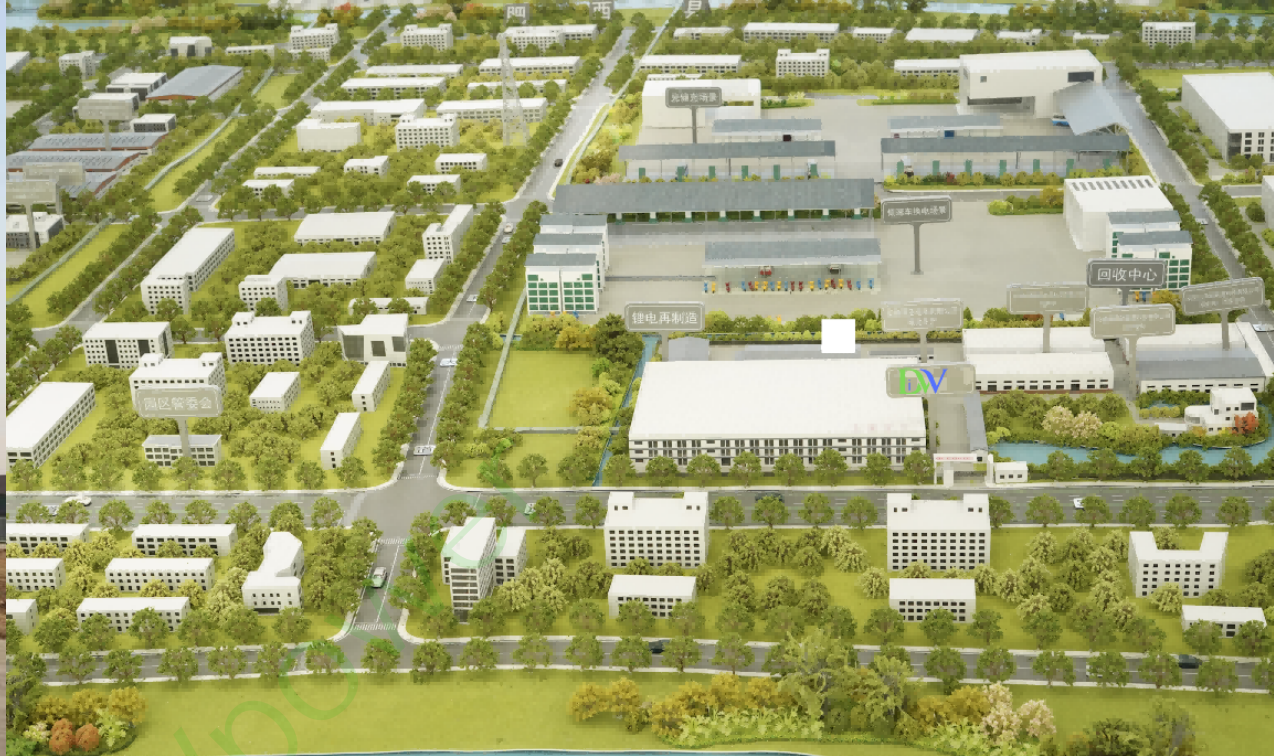



# Thanks

# DAW Power Technology Co., Ltd

Office address: Room 801, Tianyue Center, Shushan District, Hefei City, Anhui

Factory address: Intersection of Shusan Road and Baihe Road in Hangbu Town, Shucheng County, Lu'an City, Anhui Province

**Brett**  
**Technical Engineer**  
**WhatsApp: +8615665457677**  
**Email: Brett@dawpower.com**